

Ring terminals

Nylon-insulated ring terminals

Note: Sta-Kon rings, forks and locking forks are tested and listed to UL 486A/B, two-way splices to UL 486C, disconnects to UL 310 and all applicable products to CSA 22.2.

Sta-Kon® rings, forks and locking forks

- Complete line of installing tools engineered to match tool with terminal
- First to gain military approval for pressure connections many styles available for military applications
- Sta-Kon products exceed test specification requirements of military, UL® and CSA



- Include extra metal sleeve to grip insulation
- Vinyl insulated and bare Sta-Kon terminals feature brazed seam wire barrels that can be crimped at any place on the barrel circumference
- Can be installed with crimping tools having a single indenter or double indenter (recommended for solid wire)
- Serrated barrel increases grip on wire
- Wire range identification on the tongue of each terminal
- Can be installed with crimping tools having a single indenter or double indenter (recommended for solid wire)
- Constructed of electrolytic copper for high conductivity
- Wire range identification on the tongue of each terminal

Nylon-insulated ring terminals



Cat. no.	Pkg. qty.	Wire range (AWG)	Max. ins. (in.)	Bolt hole (in.)	Rec. tool	Dimensions (in.)				Stock thick. (in.)
						A	B	C	M	
RZ22-2**	100	26-22	0.083	#2	ERG4006	0.57	0.14	0.13	0.49	0.02
RZ22-4**	100	26-22	0.083	#4		0.65	0.21	0.20	0.54	0.02
RZ22-6**	100	26-22	0.083	#6		0.65	0.21	0.20	0.54	0.02
RZ22-8**	100	26-22	0.083	#8		0.75	0.25	0.23	0.62	0.02
RZ22-10**	100	26-22	0.083	#10		0.75	0.25	0.23	0.62	0.02
RAX23*	1,000	26-24	0.125	#2	WT145A	0.66	0.14	0.14	0.59	0.02
RAX43*	1,000	26-24	0.125	#4		0.74	0.20	0.19	0.64	0.02
RAX63*	1,000	26-24	0.125	#6		0.84	0.25	0.22	0.72	0.02
RAX83*	1,000	26-24	0.125	#8		0.84	0.25	0.22	0.72	0.02
RAX103*	1,000	26-24	0.125	#10		0.84	0.25	0.24	0.72	0.02
RA18-4	100	22-16	0.136	#4	ERG4001	0.72	0.23	0.14	0.59	0.03
RA323	1,000	22-16	0.136	#4		0.72	0.23	0.14	0.59	0.03
RA333	1,000	22-16	0.136	#6		0.72	0.23	0.14	0.59	0.03
RA18-6	100	22-16	0.136	#6		0.86	0.26	0.25	0.71	0.03

* Not listed by UL or CSA

** CSA listed only

Cat. no.	Pkg. qty.	Wire range (AWG)	Max. ins. (in.)	Bolt hole (in.)	Rec. tool	Dimensions (in.)				Stock thick. (in.)
						A	B	C	M	
RA853	1,000	22-16	0.136	#6	WT145A	0.86	0.26	0.25	0.71	0.03
RA18-8	100	22-16	0.136	#8		0.89	0.26	0.25	0.71	0.03
RA833	1,000	22-16	0.136	#8		0.86	0.26	0.25	0.71	0.03
RA863	1,000	22-16	0.136	#8		0.89	0.26	0.25	0.71	0.03
RA18-10	100	22-16	0.136	#10		0.89	0.31	0.25	0.71	0.03
RA873	1,000	22-16	0.136	#10		0.89	0.31	0.25	0.71	0.03
RA18-14	100	22-16	0.136	¾		1.10	0.46	0.31	0.84	0.03
RA713	1,000	22-16	0.136	¾		1.10	0.46	0.31	0.84	0.03
RA18-516	100	22-16	0.136	5/16		1.10	0.46	0.31	0.84	0.03
RA723	1,000	22-16	0.136	5/16	ERG4001	1.10	0.46	0.31	0.84	0.03
RA18-38	100	22-16	0.136	¾		1.20	0.53	0.35	0.87	0.03
RA733	1,000	22-16	0.136	¾		1.20	0.53	0.35	0.87	0.03
RA18-12	100	22-16	0.136	½		1.30	0.72	0.50	0.92	0.03
RA753	1,000	22-16	0.136	½		1.30	0.72	0.50	0.92	0.03

Diagram

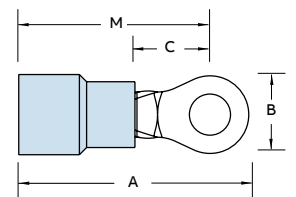

Flag terminals

Non-insulated flags



Non-insulated flags



Cat. no.	Pkg. qty.	Wire range (AWG)	Bolt hole (in.)	Rec. tool	Dimensions (in.)				Stock thick. (in.)
					A	B	C	M	
AB14-6A	100	22-14	#6	ERG4004	0.55	0.31	0.22	0.39	0.03
AB51	1,000	22-14	#6		0.55	0.31	0.22	0.39	
AB14-8A	100	22-14	#8		0.55	0.31	0.22	0.39	
AB52	1,000	22-14	#8		0.55	0.31	0.22	0.39	
AB14-10A	100	22-14	#10		0.55	0.31	0.22	0.39	
AB53	1,000	22-14	#10		0.55	0.31	0.22	0.39	
C51	500	12-10	#6		0.66	0.31	0.25	0.48	0.04
C10-8A	50	12-10	#8		0.66	0.31	0.25	0.48	
C52	500	12-10	#8		0.66	0.31	0.25	0.48	
C10-10A	50	12-10	#10		0.66	0.31	0.25	0.48	
C53	500	12-10	#10		0.66	0.31	0.25	0.48	
D236	200	8	#10	WT129	0.83	0.50	0.25	0.59	0.06
D226	200	8	#10		0.90	0.50	0.29	0.64	
D271	200	8	1/4		0.92	0.50	0.33	0.68	
E226	200	6	#10		0.93	0.50	0.29	0.69	0.06
E271	200	6	1/4		0.99	0.50	0.33	0.73	
E272	200	6	5/16		1.05	0.50	0.41	0.81	
F226	200	4	#10		1.07	0.56	0.33	0.80	
F271	200	4	1/4		1.10	0.63	0.33	0.80	0.07
F272	200	4	5/16		1.18	0.63	0.41	0.88	
F273	200	4	3/8		1.20	0.63	0.43	0.90	
G671	100	2	1/4		1.20	0.63	0.33	0.89	0.08
G672	100	2	5/16		1.28	0.63	0.41	0.97	
G673	100	2	3/8		1.32	0.63	0.46	1.02	
H672	50	1/0	5/16	13642M	1.31	0.63	0.41	1.01	0.10
H673	50	1/0	3/8		1.36	0.63	0.46	1.06	
J672	50	2/0	5/16		1.46	0.75	0.41	1.10	0.10
J673	50	2/0	3/8		1.51	0.75	0.46	1.15	
J675	50	2/0	1/2		1.67	0.75	0.55	1.24	
K672	50	3/0	5/16		1.59	0.81	0.41	1.19	0.11
K673	50	3/0	3/8		1.64	0.81	0.46	1.24	
K675	50	3/0	1/2		1.76	0.81	0.55	1.34	
M673	50	250 kcmil	3/8		1.89	1.0	0.46	1.43	0.13
M675	50	250 kcmil	1/2		1.99	1.0	0.55	1.52	

Diagram

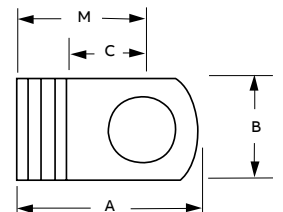

Wire termination technical information

Cat. no. ABB distributor package	Cat. no. ABB bulk package	Cat. no. ABB distributor package	Cat. no. ABB bulk package	Cat. no. ABB distributor package	Cat. no. ABB bulk package	Cat. no. ABB distributor package	Cat. no. ABB bulk package
10RC-10	RC367	14RB-6FX	RB647-200	2A-18	AA2	18RAD-18277	RAD18277
10RC-10F	RC1157	14RB-6X	RB857-200	2A20	RAA24	18RAD-183	RAD1837
10RC-10FL	RC2227	14RB-8	RB867	2A22-20	A1A	18RAD-18377	RAD18377
10RC-10FLX	RC2227-250	14RB-8F	RB657	2B-14	BB2	2A-18	AA2
10RC-10FX	RC1157-250	14RB-8FL	RB2237	2B-16	RBB25	2A-18	AA2
10RC-10X	RC367-250	14RB-8FLX	RB2237-200	2B18-16	B1B	2A20	RAA24
10RC-14	RC717	14RB-8FX	RB657-200	2C-10	CC2-TB	2A22-20	A1A
10RC-14F	RC1167	14RB-8X	RB867-200	2C-12	RCC26	2B-14	BB2
10RC-14FL	RC2237	14RBC-10	RBC877	2C14-12	C1C	2B-16	RBB25
10RC-14X	RC717-250	14RBC-12	RBC757	2D10-9	D1D	2B18-16	B1B
10RC-250F	RC257	14RBC-14	RBC717	2D-8	DD102	2C-10	CC2-TB
10RC-250T	RC2517	14RBC-38	RBC797	2.00E-06	EE2	2C-12	RCC26
10RC-251T	RC25177	14RBC-516	RBC727	2E8-7	E1E	A18-250A	A252G
10RC-2577	RC2573	14RBC-6	RBC857	2F-4	FF2	A18-251T	A251
10RC-38	RC737	14RBD-182	RBD1827	2F6-5	F1F	A18-38	A73
10RC-38X	RC737-250	14RBD-18277	RBD18277	2G21	GG2	A18-516	A72
10RC-516	RC707	14RBD-183	RBD1837	2G4-2	G1G	A18-6	A85
10RC-55PT	RC55PT	14RBD-18377	RBD18377	2RA18	RAA21	A18-6F	A116
10RC-6	RC337	18RA-10	RA877	2RA18X	RAA217-170	A18-6FL	A221
10RC-6F	RC1337	18RA-10F	RA1157	2RAA	RAA23	A18-8	A86
10RC-6FL	RC2207	18RA-10FL	RA2257	2RAS18X	RAAS22X	A18-8F	A114
10RC-6FLX	RC2207-250	18RA-10FLX	RA2257-170	2RB14	RBB21	A18-8FL	A224
10RC-6X	RC337-250	18RA-10X	RA877-170	2RB14X	RBB217-200	AB14-10A	AB53
10RC-8	RC777	18RA-14	RA717	2RBB	RBB23	AB14-6A	AB51
10RC-8F	RC1147	18RA-250F	RA257	2RBS14X	RBBS22X	AB14-8A	AB52
10RC-8FL	RC2217	18RA-250T	RA2517	2RC10	RCC21	AD18-182	AD182
10RC-8FLX	RC2217-250	18RA-251T	RA25177	2RC10X	RCC217-250	AD18-183	AD183
10RC-8X	RC777-250	18RA-2577	RA2573	2RCC	RCC23	B14-10	B87
14RB-10	RB877	18RA-38	RA737	2RCS10X	RCCS22X	B14-10F	B115
14RB-10F	RB1157	18RA-4	RA77	2RD8	RDD27	B14-10FL	B225
14RB-10FL	RB2257	18RA-47PT	RA47PT	2RE6	REE28	B14-10G	B87G
14RB-10FLX	RB2257-200	18RA-516	RA727	2RZZ	RZZ23	B14-110F	B10TB
14RB-10FX	RB1157-200	18RA-516X	RA727-170	A18-10	A87	B14-111F	B11-TB
14RB-10X	RB877-200	18RA-6	RA857	A18-10F	A115-TB	B14-12	B75TB
14RB-14	RB717	18RA-6F	RA1167	A18-10FL	A225	B14-14	B71
14RB-14F	RB1717	18RA-6FL	RA2217	A18-110F	A10-TB	B14-250	B250
14RB-14X	RB717-200	18RA-6FLX	RA2217-170	A18-111F	A11	B14-250A	B252G
14RB-250F	RB257	18RA-6FX	RA1167-170	A18-12	A75	B14-250F	B250G
14RB-250T	RB2517	18RA-6X	RA857-170	A18-14	A71	B14-250T	B251G
14RB-251T	RB25177	18RA-8	RA867	A18-250	A250-TB	B14-251T	B251
14RB-2577	RB2573	18RA-8F	RA1147	18RA-6FLX	RA2217-170	B14-38	B73
14RB-38	RB737	18RA-8FL	RA2247	18RA-6FX	RA1167-170	B14-4	B132
14RB-4	RB1327	18RA-8FX	RA1147-170	18RA-6X	RA857-170	B14-516	B72
14RB-47PT	RB47PT	18RA-8X	RA867-170	18RA-8	RA867	B14-6	B133
14RB-516	RB727	18RAD-182	RAD1827	18RA-8F	RA1147	B14-6F	B64
14RB-6	RB857	18RAD-18277	RAD18277	18RA-8FL	RA2247	B14-6FL	B220
14RB-6F	RB647	18RAD-183	RAD1837	18RA-8FX	RA1147-170	B14-8	B86
14RB-6FL	RB2207	18RAD-18377	RAD18377	18RA-8X	RA867-170	B14-8F	B65TB
14RB-6FLX	RB2207-200	2A-18	AA2	18RAD-182	RAD1827	B14-8FL	B223

Note: All catalog numbers do not appear in this cross reference. This means it may not be available in one of the package options.