

Features

- Current carrying (fusing) capacity equal to that of the conductor
- Permanent molecular bond will not loosen or corrode over time
- No special skills are required for use
- No external power or heat required
- Connections can be checked for quality by visual inspection
- Low labor costs
- Made with inexpensive, lightweight and portable equipment
- Can be used with either traditional CADWELD® welding material or CADWELD® PLUS



	Mold Part Number	CADWELD® Welding Material Part Number	CADWELD® PLUS Part Number
	GRC168C	115	115PLUSF20
	GRC188C	115	115PLUSF20
	GRC188G	115	115PLUSF20
	GTC168C	150	150PLUSF20
	GTC168D	150	150PLUSF20
	GTC188C	150	150PLUSF20
	GTC188D	150	150PLUSF20
	GTC188G	200	200PLUSF20
	TAC2Q8C	115	115PLUSF20
	TAC2Q8D	115	115PLUSF20
	TAC2Q8G	150	150PLUSF20
	TAC8C8C	115	115PLUSF20
	TAC8D8C	115	115PLUSF20
	TAC8D8D	115	115PLUSF20
	TAC8G8G	150	150PLUSF20

Accessories



L160
Handle Clamps
(Includes T320)



T111
Surefire™
Torch Head



T321
Rasp



T320
Flint Ignitor



T313
Card
Cleaning
Brush



T394
Mold
Cleaning
Brush



PLUSCU
CADWELD® PLUS
Control Unit



T314
Cable
Cleaning
Brush



T403
Mold
Sealer



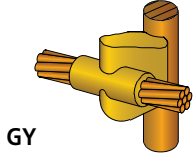

GY

Mold Part Number	CADWELD® Welding Material Part Number	CADWELD PLUS Part Number
GYE188C	150	150PLUSF20
GYE188D	150	150PLUSF20

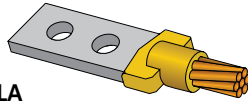

LA

Mold Part Number	CADWELD Welding Material Part Number	CADWELD PLUS Part Number
LAC8G001	150	150PLUSF20

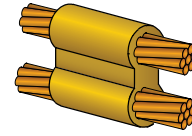

PT

Mold Part Number	CADWELD Welding Material Part Number	CADWELD PLUS Part Number
PTC2Q8C	150	150PLUSF20
PTC8C1V	115	115PLUSF20
PTC8C8C	150	150PLUSF20
PTC8D8D	200	200PLUSF20

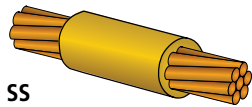

SS

Mold Part Number	CADWELD Welding Material Part Number	CADWELD PLUS Part Number
SSC8C	65	65PLUSF20
SSC8D	90	90PLUSF20

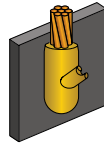

VF

Mold Part Number	CADWELD Welding Material Part Number	CADWELD PLUS Part Number
VFC8C	115	115PLUSF20

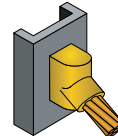

VS

Mold Part Number	CADWELD Welding Material Part Number	CADWELD PLUS Part Number
VSC8C	90	90PLUSF20
VSC8D	115	115PLUSF20

The CADWELD Mold Numbering System

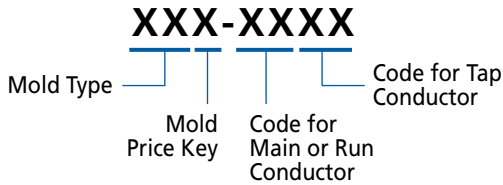

Examples

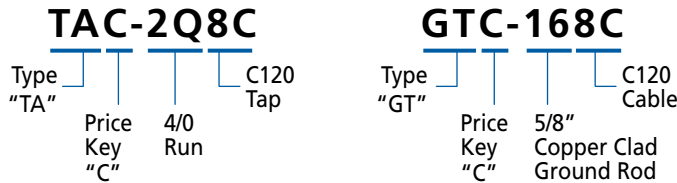

CADWELD® Codes	
16	5/8" Copper Clad Ground Rod
18	3/4" Copper Clad Ground Rod
8C*	LPC120, LPC121, LPC122 Lightning Conductor
8D*	LPC125, LPC126R, LPC128 Lightning Conductor
8G*	LPC124 Lightning Conductor
2Q*	4/0 Concentric Stranded, LPC137, LPC404
1V*	#2 Concentric Stranded

*For other cable sizes, please contact ERICO®.

Surefire is a trademark of the Newell Company.

WARNING
ERICO products shall be installed and used only as indicated in ERICO's product instruction sheets and training materials. Instruction sheets are available at www.erico.com and from your ERICO customer service representative. Improper installation, misuse, misapplication or other failure to completely follow ERICO's instructions and warnings may cause product malfunction, property damage, serious bodily injury and death.

WARRANTY
ERICO products are warranted to be free from defects in material and workmanship at the time of shipment. NO OTHER WARRANTY, WHETHER EXPRESS OR IMPLIED (INCLUDING ANY WARRANTY OF MERCHANTABILITY OR FITNESS FOR A PARTICULAR PURPOSE), SHALL EXIST IN CONNECTION WITH THE SALE OR USE OF ANY ERICO PRODUCTS. Claims for errors, shortages, defects or nonconformities ascertainable upon inspection must be made in writing within 5 days after Buyer's receipt of products. All other claims must be made in writing to ERICO within 6 months from the date of shipment or transport. Products claimed to be nonconforming or defective must, upon ERICO's prior written approval in accordance with its standard terms and procedures governing returns, promptly be returned to ERICO for inspection. Claims not made as provided above and within the applicable time period will be barred. ERICO shall in no event be responsible if the products have not been stored or used in accordance with its specifications and recommended procedures. ERICO will, at its option, either repair or replace nonconforming or defective products for which it is responsible or return the purchase price to the Buyer. THE FOREGOING STATES BUYER'S EXCLUSIVE REMEDY FOR ANY BREACH OF ERICO WARRANTY AND FOR ANY CLAIM, WHETHER SOUNDING IN CONTRACT, TORT OR NEGLIGENCE, FOR LOSS OR INJURY CAUSED BY THE SALE OR USE OF ANY PRODUCT.

LIMITATION OF LIABILITY
ERICO excludes all liability except such liability that is directly attributable to the willful or gross negligence of ERICO's employees. Should ERICO be held liable its liability shall in no event exceed the total purchase price under the contract. ERICO SHALL IN NO EVENT BE RESPONSIBLE FOR ANY LOSS OF BUSINESS OR PROFITS, DOWNTIME OR DELAY, LABOR, REPAIR OR MATERIAL COSTS OR ANY SIMILAR OR DISSIMILAR CONSEQUENTIAL LOSS OR DAMAGE INCURRED BY BUYER.

Copyright ©2009 ERICO International Corporation. All rights reserved.
CADDY, CADWELD, CRITEC, ERICO, ERIFLEX, ERITECH, and LENTON are registered trademarks of ERICO International Corporation.