

## Concrete Inserts

Buildings designed with concrete inserts as an integral part of the ceiling or wall construction realize many economies, both in initial construction and when updating of the mechanical and electrical system is required. The initial economies of construction stem from the ease with which pipe, air conditioning, lighting and other fixtures can be attached to ceilings or walls.

Inserted by casting into the structure, Kindorf® continuous-slot channels will accept all the assembly parts and fittings of the Kindorf® system. This provides virtually limitless structural arrangements — present and future.

Hanger attachments are made by the standard Kindorf® procedure of simply inserting a standard channel nut which can be pre-started on the hanger rod or bolt. Placement or adjustment of attachments can be made in infinite increments at any time along the length of the concrete insert. Future flexibility means economies in terms of future changes in equipment or its placement.

### Initial Installation of Continuous-Slot Channel Inserts Offers:

- An immediate savings in time and labor by eliminating the need for precise calculation and measurement, both in layout planning and actual installation of attachment devices
- Additional savings in time and labor because changes or additions can be made readily to the existing channel at any time; the need for costly drilling in concrete and other costly procedures can be eliminated

Companion to the channel inserts is the spot-type insert for use where a single hanger is required at a specific location.

### D-255 Concrete Inserts

An insert with a knockout saves covering the slot or covering the opening. Load rating at 1,300 lbs. with a safety factor of 3. Accommodates hanger rod sizes from 1/4" through 3/8" by means of a B-914 insert nut. 1/8" steel. 52 lbs./C.

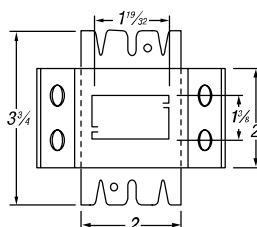
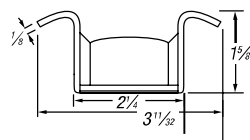
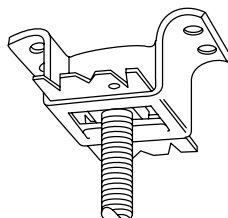

CAT. NO.	DESCRIPTION
D-255	For 1/4" through 3/8" Hanger Rod — 1/4"—1/2" Pipe
Standard finish: Galv-Krom®.	

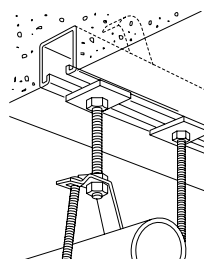

Pipe section hangs from D-990 concrete insert.

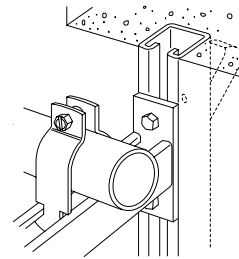

D-990 concrete insert supports conduit installation.

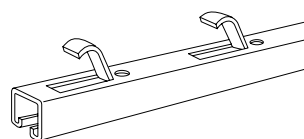

D-990

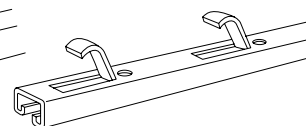

D-996

CAT. NO.	TYPE ANCHOR	CROSS-SECTION	LOAD RATING LBS. PER FT.*
D-990	Punched	1 1/2 x 1 1/2 x 12 ga.	2,000
D-996	Punched	1 1/2 x 3/4 x 14 ga.	1,500

\* Safety factor of 3. Based on uniformly distributed load.

\* Standard lengths 10 and 20 feet.

\* Special lengths available on request.

### D-256-2 and D-256-5 Concrete Insert

This unique product reduces the "spot" concrete insert to its simplest possible components with all the adjustability of the most expensive. Its features include: two sizes — 2" and 5" adjustability, takes standard insert nuts, uses hanger rod sizes 1/4" through 3/8" and has a load rating up to 1,000 lbs. and a safety factor of 3 (hanger rod permitting).

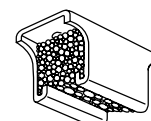
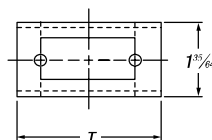

D-256-2

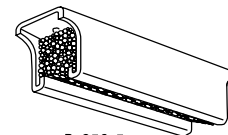
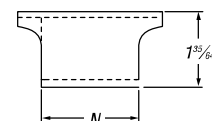

D-256-5



CAT. NO.	N (IN.)	T (IN.)	WT. IN LBS./C
D-256-2	2	3	34
D-256-5	5	6	76

\* Standard finish: Galv-Krom®.