

# AJT Reducer Fuses

Time-delay/Class J

## AMP-TRAP 2000® FUSES

DECREASE YOUR CURRENT RATING WITHOUT  
USING A FUSE REDUCER



AJT Reducer Fuses are a safe permanent solution for decreasing your current rating without using a fuse reducer which are designed and list for temporary use only. These reducer fuses provide the same trusted protection levels as a traditional AJT fuses but in a larger body.

### FEATURES/BENEFITS:

- Replaces traditional temporary use only fuse reducers
- Recommended for Arc Flash energy reduction
- Extremely current-limiting for low peak let-thru current
- Most current-limiting UL class fuse
- Time-delay for motor starting and transformer inrush
- High-visibility orange label gives instant brand recognition
- Metal-embossed date and catalog number for traceability and lasting identification
- Fiberglass body provides dimensional stability in harsh industrial settings
- High-grade silica filler ensures fast arc quenching
- Optional EI indicator/switch

### HIGHLIGHTS:

- Reducer Fuse
- Arc Flash mitigating
- Highly current-limiting
- Time-delay
- DC ratings
- Optional mechanical indicator

### RATINGS:

**Volts:** 600VAC or less, 500VDC or less

**Amps:** 125 to 200A (in 400A body), 250 to 400A (in 600A body)

**IR:** 200kA I.R. AC, 100kA I.R. DC (Self-certified for 600VAC, 300kA I.R., UL witnessed).

### APPROVALS:

#### AJT (1-600):

- UL listed to standard 248-8 File E2137
- IEC 269-2-1



### APPLICATIONS:

- Motor circuits
- Mains
- Feeders
- Branch circuits
- Lighting, heating & general loads
- Transformers
- Control panels
- Circuit breaker back-up
- Bus duct
- Load centers

*Note: See motor fuse applications tables on page P7*

CATALOG NUMBERS (AMPS) RECOMMENDED FUSE BLOCKS  
WITH BOX CONNECTORS FOR  
AMP-TRAP® CLASS J FUSES

| Catalog Numbers | Amp Rating | Body Size |
|-----------------|------------|-----------|
| AJT125/400      | 125A       | 400A      |
| AJT150/400      | 150A       |           |
| AJT175/400      | 175A       |           |
| AJT200/400      | 200A       |           |
| AJT250/600      | 250A       | 600A      |
| AJT300/600      | 300A       |           |
| AJT350/600      | 350A       |           |
| AJT400/600      | 400A       |           |

| Fuse Ampere<br>Rating | Catalog Number<br>600V or Less |        |
|-----------------------|--------------------------------|--------|
|                       | 1 Pole                         | 3 Pole |
| 125/400-<br>200/400   | 64031J                         | 64033J |
| 250/600-<br>400/600   | 6631J                          | 6633J  |

A variety of pole configurations and termina-  
tion provisions are available. See section H.

DIMENSIONS

| Ampere Rating       | A     |     | B     |    | C   |     | D     |    | E     |    | F     |     | G     |    | H     |    |
|---------------------|-------|-----|-------|----|-----|-----|-------|----|-------|----|-------|-----|-------|----|-------|----|
|                     | in    | mm  | in    | mm | in  | mm  | in    | mm | in    | mm | in    | mm  | in    | mm | in    | mm |
| 125/400-<br>200/400 | 7-1/8 | 181 | 2-1/8 | 54 | 1/4 | 6.3 | 1-5/8 | 41 | 1-7/8 | 48 | 5-1/4 | 133 | 17/32 | 14 | 13/32 | 10 |
| 250/600-<br>400/600 | 8     | 203 | 2-1/2 | 64 | 3/8 | 9.5 | 2     | 51 | 2-1/8 | 54 | 6     | 152 | 11/16 | 18 | 17/32 | 13 |

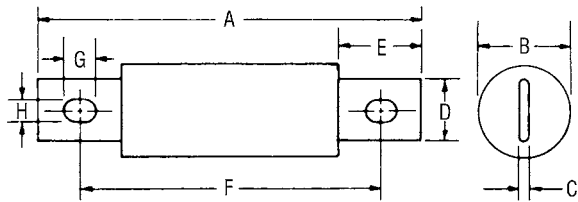

70-600A

OPTIONAL INDICATOR/MICROSWITCH MOUNT (EI) DIMENSIONS:

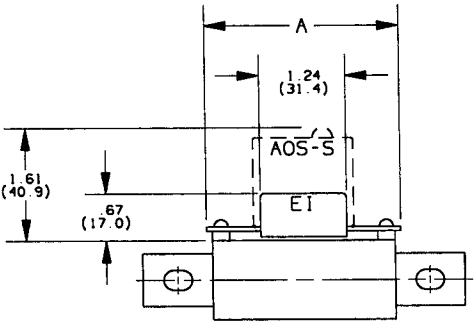

Note: Fuses with the EI option are  
designed to work with the AOS-S  
or AOS-Q add-on switch, which is  
ordered separately. See page J6 for  
details.

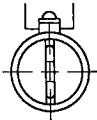

| Catalog Number           | A           |
|--------------------------|-------------|
| AJT (125/400-200/400)-EI | 3.24 (82.2) |
| AJT (250/600-400/600)-EI | 3.61 (91.8) |