

REV	DESCRIPTION	DATE	APPD
00	RELEASED		
01	REVISED PER ECO		

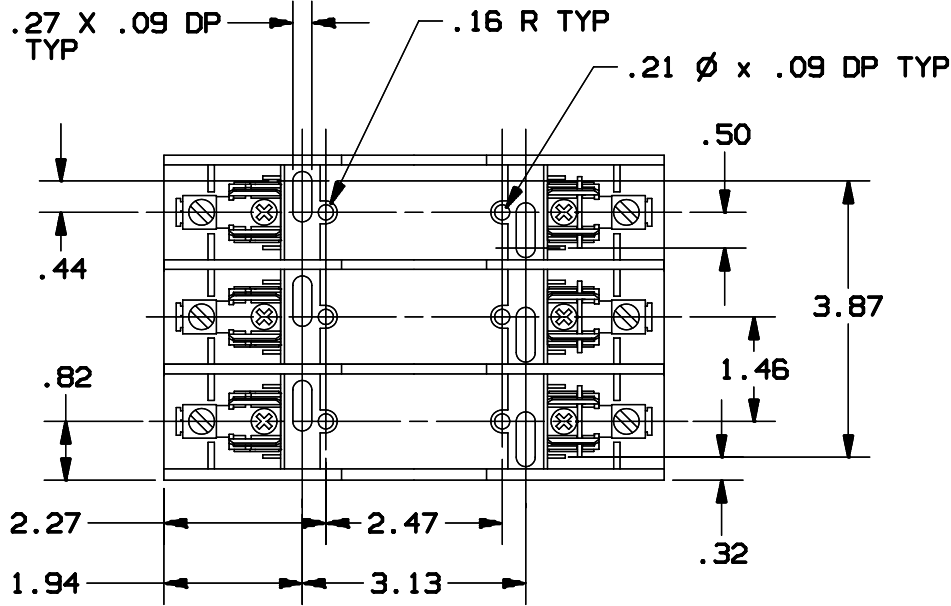

P/N	FUSE CLASS	RMS SYM RATING	TORQUE (IN-LBS)	WIRE		UL		CSA
				°C	TYPE	FILE NO.	GUIDE NO.	REPORT NO.
60303 [2]	H.K	10K	35	60/75	CU-AL	E52283	IZLT	LR32169
60308 60358 [3]	H.K	10K	35	60/75	CU-AL CU ONLY			
60308R 60358R	R	200K	35	60/75	CU-AL CU ONLY			

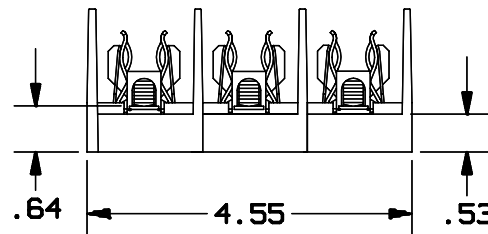
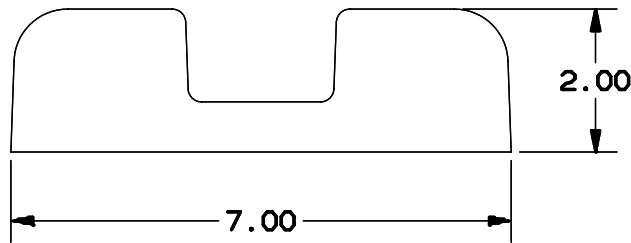

P/N 60303
P/N 60308(R) SPRF
P/N 60358(R) SPRF
ADD 'R' FOR CLASS R

[3] OMIT REJECTION.

[2] OMIT SPRING AND REJECTION.

1. MATL COMPOSITION AND RATING:
THERMOPLASTIC-125°C RTI.

NOTES: UNLESS OTHERWISE SPECIFIED

WILLIAMS 2/90

FUSE BLOCK, 600V-
30A 3 POLE BOX
CONNECTOR

05B0261

01

NONE

1 1