

# Totally Integrated Power

## Current & Voltage Transformers (Metering Grade)

Selection



### Low Voltage Current Transformers (Metering Grade)

Primary	Description	Secondary	Accuracy	Catalog Number
<b>Split Core - Rectangular Metering Grade, 600V, 0.5% Accuracy</b>				
100A	1.25" x 1.51" Window	5A Output		PDS-CTSC-011
200A	1.25" x 1.51" Window	5A Output		PDS-CTSC-021
300A	1.25" x 1.51" Window	5A Output		PDS-CTSC-031
400A	2.45" x 2.89" Window	5A Output		PDS-CTSC-042
600A	2.45" x 2.89" Window	5A Output		PDS-CTSC-062
800A	2.45" x 2.89" Window	5A Output		PDS-CTSC-082
1000A	2.45" x 5.50" Window	5A Output		PDS-CTSC-013
1200A	2.45" x 5.50" Window	5A Output		PDS-CTSC-123
1600A	2.45" x 5.50" Window	5A Output		PDS-CTSC-163
2000A	2.75" x 6.625" Window	5A Output		PDS-CTSC-02R
3000A	2.75" x 6.625" Window	5A Output		PDS-CTSC-03R
<b>Split Core - Round Metering Grade, 600V</b>				
200A	4.0" Window	5A Output	4% Accuracy	PDS-CTHC-024
300A	4.0" Window	5A Output	4% Accuracy	PDS-CTHC-034
400A	4.0" Window	5A Output	3% Accuracy	PDS-CTHC-044
600A	4.0" Window	5A Output	2% Accuracy	PDS-CTHC-064
800A	4.0" Window	5A Output	2% Accuracy	PDS-CTHC-084
1200A	4.0" Window	5A Output	2% Accuracy	PDS-CTHC-124
3000A	6.0" Window	5A Output	2% Accuracy	PDS-CTHC-306
2000A	6.0" Window	5A Output	2% Accuracy	PDS-CTHC-206
4000A	6.0" Window	5A Output	2% Accuracy	PDS-CTHC-406
<b>Solid Core - Round Metering Grade, 600V, 0.3 % Accuracy</b>				
200A	1.25" Window	5A Output		PDS-CTRC-021
300A	1.25" Window	5A Output		PDS-CTRC-031
400A	1.25" Window	5A Output		PDS-CTRC-041
500A	1.25" Window	5A Output		PDS-CTRC-051
600A	1.25" Window	5A Output		PDS-CTRC-061
800A	1.25" Window	5A Output		PDS-CTRC-081
1000A	1.25" Window	5A Output		PDS-CTRC-101
100A	2.25" Window	5A Output		PDS-CTRC-012
200A	2.25" Window	5A Output		PDS-CTRC-022
300A	2.25" Window	5A Output		PDS-CTRC-032
400A	2.25" Window	5A Output		PDS-CTRC-042
800A	4.0" Window	5A Output		PDS-CTRC-084
1000A	4.0" Window	5A Output		PDS-CTRC-104
1200A	4.0" Window	5A Output		PDS-CTRC-124
1600A	4.0" Window	5A Output		PDS-CTRC-164
2000A	4.0" Window	5A Output		PDS-CTRC-204
3200A	6.5" Window	5A Output		PDS-CTRC-326
4000A	6.5" Window	5A Output		PDS-CTRC-426
<b>Solid Core - Round Metering Grade, 600V, 0.3 % Accuracy</b>				
100A	1.75" x 2.47", 1" Window	5A Output		SMU-CT-011
200A	1.75" x 2.47", 1" Window	5A Output		SMU-CT-021
250A	1.75" x 2.47", 1" Window	5A Output		SMU-CT-025
300A	1.75" x 2.47", 1" Window	5A Output		SMU-CT-031
400A	1.1" x 3.56", 1.56" Window	5A Output		SMU-CT-041
600A	1.1" x 3.56", 1.56" Window	5A Output		SMU-CT-061
800A	1.1" x 3.56", 1.56" Window	5A Output		SMU-CT-081
1000A	1.1" x 3.56", 1.56" Window	5A Output		SMU-CT-123
2000A	1.15" x 5.73", 3.25" Window	5A Output		SMU-CT-02R
2500A	1.15" x 5.73", 3.25" Window	5A Output		SMU-CT-25R
3000A	1.15" x 5.73", 3.25" Window	5A Output		SMU-CT-30R
4000A	1.15" x 5.73", 3.25" Window	5A Output		SMU-CT-40R

### Voltage Transformers - Metering Grade, 600V and 5KV, +/- 1% Accuracy at all burdens up to 5VA at 1.0 and .95 pf

Catalog Number	Description	Primary	Secondary
467-480	Potential Transformer (4:1)	480 V	120 V
467-288	Potential Transformer, 277:120V L-N 2.4:1	277 V	120 V
PTW3-2-60-242	Potential Transformer, 2 BUSHINGS, NO FUSES	2400 V	120 V
PTW5-2-110-722	Potential Transformer, 2 BUSHINGS, NO FUSES	7200 V	120 V

# ACCESS 600V Current Transformers



## Comprehensive Metering Grade CT Offering

Split-Core, Flexible and Solid core designs

### Split Core - Rectangular Window

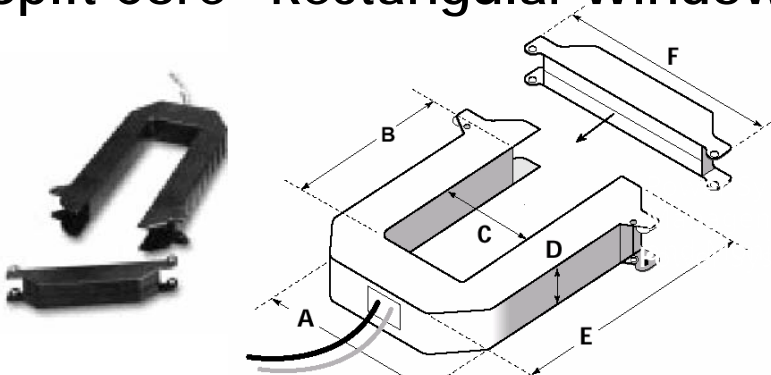

**200A - 300A**

**400A - 800A**

**1000A - 1200A**

A = 3.75" (95 mm)	A = 4.90" (124 mm)	A = 4.90" (124 mm)
B = 1.51" (38 mm)	B = 2.89" (73 mm)	B = 5.50" (140 mm)
C = 1.25" (32 mm)	C = 2.45" (62 mm)	C = 2.45" (62 mm)
D = 1.13" (29 mm)	D = 1.13" (29 mm)	D = 1.13" (29 mm)
E = 4.20" (107 mm)	E = 5.57" (141 mm)	E = 8.13" (207 mm)
F = 4.75" (121 mm)	F = 5.91" (150 mm)	F = 5.92" (150 mm)

Siemens Instrument Grade Current Transformers (CT) have a Split-Core construction and provide a safe 5A secondary output. These Split Core Current Transformers allow for easy installation, retrofit, and service. CT's come with 4' leads (18 gauge). Use on low Voltage applications of 600V or less.

Amps	Window (C x B)	Catalog #	Accuracy
200A	1.25"x1.51"	PDS-CTSC-021	1%
300A	1.25"x1.51"	PDS-CTSC-031	1%
400A	2.45"x2.89"	PDS-CTSC-042	1%
600A	2.45"x2.89"	PDS-CTSC-062	1%
800A	2.45"x2.89"	PDS-CTSC-082	1%
1000A	2.45"x5.50"	PDS-CTSC-013	1%
1200A	2.45"x5.50"	PDS-CTSC-123	1%
2000A	2.75"x6.625"	PDS-CTSC-02R	1%
3000A	2.75"x6.625"	PDS-CTSC-03R	1%

### Split Core - Round Window

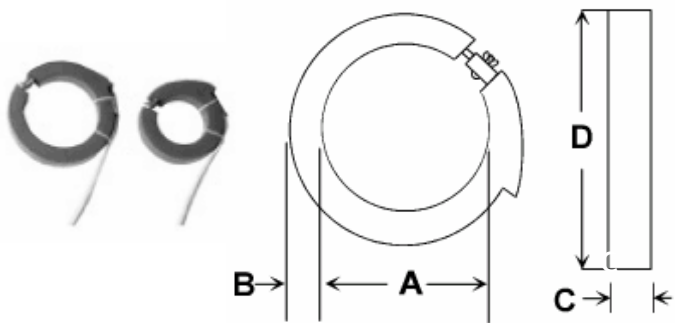

**200A - 1200A**

**3000A - 4000A**

A = 4.00"	A = 6.00"
B = 1.25"	B = 1.25"
C = 1.50"	C = 1.50"
D = 6.50"	D = 8.50"

Siemens Split-Core Round Flexible CT's come with 4' leads (18 gauge). Use on low Voltage applications of 600V or less and provide a safe 5A secondary output.

Amps	Window (A)	Catalog #	Accuracy
200A	4.00"	PDS-C THC-024	4%
300A	4.00"	PDS-C THC-034	4%
400A	4.00"	PDS-C THC-044	3%
600A	4.00"	PDS-C THC-064	2%
800A	4.00"	PDS-C THC-084	2%
1200A	4.00"	PDS-C THC-124	2%
3000A	6.00"	PDS-C THC-306	2%
4000A	6.00"	PDS-C THC-406	2%

## Solid Core - Square with Round Window

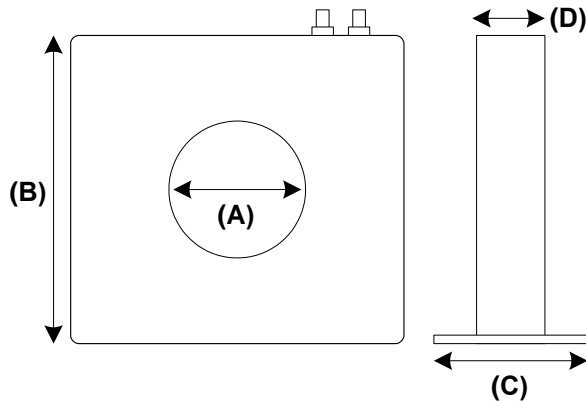

Siemens Instrument Grade Current Transformers (CT) are both designed as Solid-Core construction and provide a safe 5A secondary output. Solid-Core CT's come with terminals for attaching leads. Use on low Voltage applications of 600V or less. **Accuracy is 0.3%.**

Amps	(A) x(B)	Catalog #
200:5	1.25" x 4.88" x 2.19" x 4.68"	PDS-CTRC-021
300:5	1.25" x 4.88" x 2.19" x 4.68"	PDS-CTRC-031
400:5	1.25" x 4.88" x 2.19" x 4.68"	PDS-CTRC-041
500:5	1.25" x 5.10" x 3.00" x 5.50"	PDS-CTRC-051
600:5	1.25" x 5.10" x 3.00" x 5.50"	PDS-CTRC-061
800:5	1.25" x 5.10" x 3.00" x 5.50"	PDS-CTRC-081
1000:5	1.25" x 5.10" x 3.00" x 5.50"	PDS-CTRC-101
100:5	2.25" x 6.31" x 3.00" x 5.82"	PDS-CTRC-012
200:5	2.25" x 6.31" x 3.00" x 5.82"	PDS-CTRC-022
300:5	2.25" x 6.31" x 3.00" x 5.82"	PDS-CTRC-032
400:5	2.25" x 6.31" x 3.00" x 5.82"	PDS-CTRC-042
800:5	4.00" x 6.44" x 3.25" x 3.25"	PDS-CTRC-084
1000:5	4.00" x 6.44" x 3.25" x 3.25"	PDS-CTRC-104
1200:5	4.00" x 6.44" x 3.25" x 3.25"	PDS-CTRC-124
1600:5	4.00" x 6.44" x 3.25" x 3.25"	PDS-CTRC-164
2000:5	4.00" x 6.44" x 3.25" x 3.25"	PDS-CTRC-204
3200:5	6.50" x 9.88" x 7.00" x 7.00"	PDS-CTRC-326
4000:5	6.50" x 9.88" x 7.00" x 7.00"	PDS-CTRC-426

## Solid Core - Round with Round Window

### Solid Core - Round Metering Grade, 600V

Part Number	Primary	Size	Secondary
SMU-CT-011	100 A	1.75"x2.47", 1" Window	5A Output
SMU-CT-021	200 A	1.75"x2.47", 1" Window	5A Output
SMU-CT-025	250 A	1.75"x2.47", 1" Window	5A Output
SMU-CT-031	300 A	1.75"x2.47", 1" Window	5A Output
SMU-CT-041	400 A	1.1"x3.56", 1.56" Window	5A Output
SMU-CT-061	600 A	1.1"x3.56", 1.56" Window	5A Output
SMU-CT-081	800 A	1.1"x3.56", 1.56" Window	5A Output
SMU-CT-123	1000 A	1.1"x3.56", 1.56" Window	5A Output
SMU-CT-02R	2000 A	1.15"x5.73", 3.25" Window	5A Output

