

**Class 52**  
**Oil Tight Push-Pull Operator**  
**Momentary & Maintained**  
 January 2008

**SFIS-5203A-0108**

**IMPORTANT**

THE INFORMATION CONTAINED HEREIN DOES NOT PURPORT TO COVER ALL DETAILS OR VARIATIONS IN EQUIPMENT, NOR TO PROVIDE FOR EVERY POSSIBLE CONTINGENCY TO BE MET IN CONNECTION WITH INSTALLATION, OPERATION OR MAINTENANCE. SHOULD FURTHER INFORMATION BE DESIRED OR SHOULD PARTICULAR PROBLEMS ARISE WHICH ARE NOT COVERED SUFFICIENTLY FOR THE PURCHASER'S PURPOSES, THE MATTER SHOULD BE REFERRED TO THE LOCAL SIEMENS SALES OFFICE.

THE CONTENTS OF THIS INFORMATION SHEET SHALL NOT BECOME PART OF OR MODIFY ANY PRIOR OR EXISTING AGREEMENT, COMMITMENT OR RELATIONSHIP. THE SALES CONTRACT CONTAINS THE ENTIRE OBLIGATION OF SIEMENS. THE WARRANTY CONTAINED IN THE CONTRACT BETWEEN THE PARTIES IS THE SOLE WARRANTY OF SIEMENS. ANY STATEMENTS CONTINUED HEREIN DO NOT CREATE NEW WARRANTIES OR MODIFY THE EXISTING WARRANTY.

## WARNING

**Hazardous voltage.**  
**Can cause death, serious personal injury, or property damage.**

To avoid electrical shock, turn off electrical power to controls before performing installation or maintenance.

Cat No.

52PP2 \_\_\_\_\_

52PP3 \_\_\_\_\_

52BP2 \_\_\_\_\_

52BP3 \_\_\_\_\_

52PP7 \_\_\_\_\_

52BP7 \_\_\_\_\_

52PR8 \_\_\_\_\_

52BR8 \_\_\_\_\_

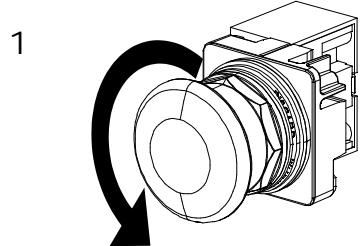

3 **Mounting Hole Pattern**  
 Typical Spacing shown. Automotive Legend plate requires 2.5" spacing. Some Accessories also require additional spacing.

**Notes for BlackMax 4X devices:**

- The trim ring is not needed or supplied.
- \* Use the locknut wrench **52MAWB**

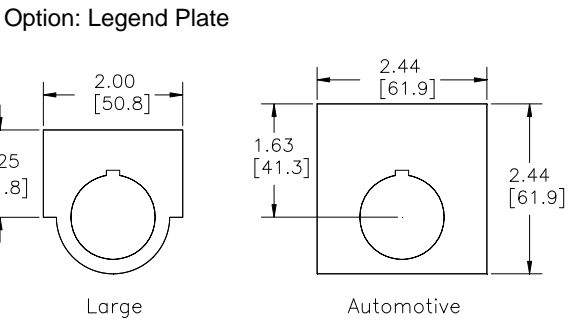
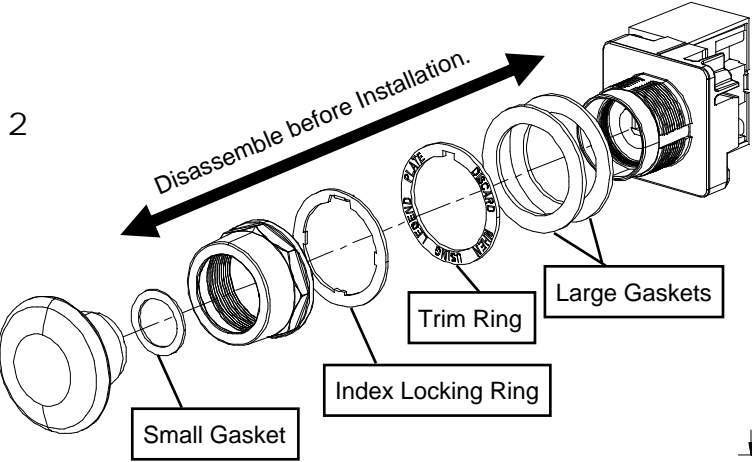
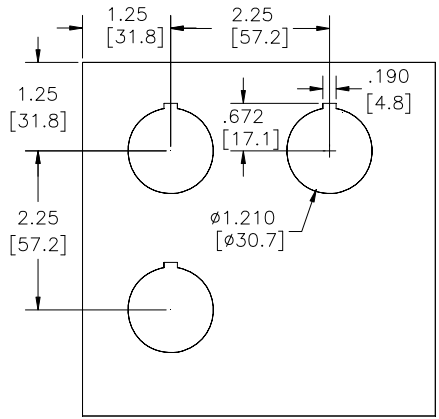

Assemble Parts shown. - Leave the Mushroom Head and small Gasket off until step # 6.

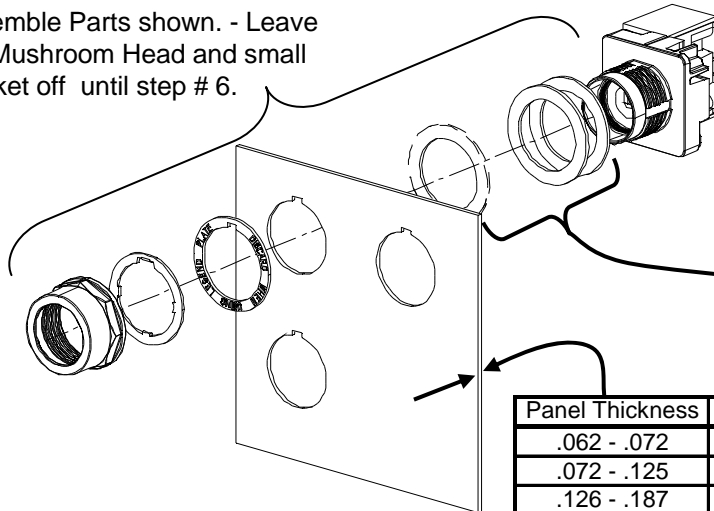

Panel Thickness	Number of Large Gaskets Required
.062 - .072	2 Large Gaskets Supplied + 2 Additional Gaskets
.072 - .125	2 Large Gaskets Supplied + 1 Additional Gasket
.126 - .187	2 Large Gaskets Supplied
Kit containing 2 Additional Large Gaskets - Cat# 52ABD	

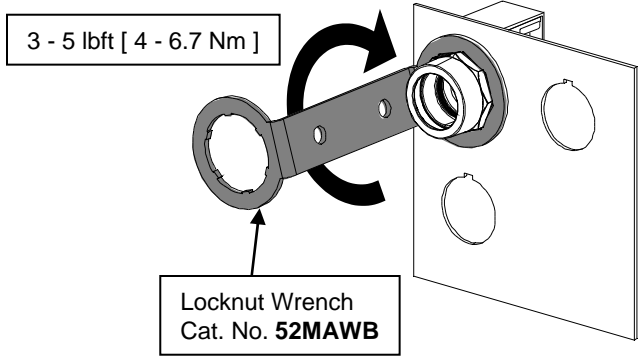

1. Place small Gasket inside nut.
2. Insert Mushroom Head into switch body.
3. Tighten securely by hand.

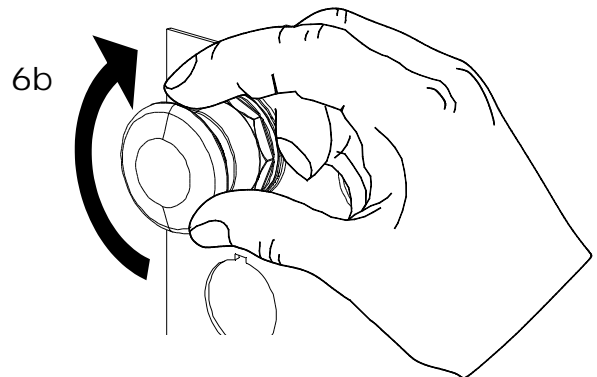
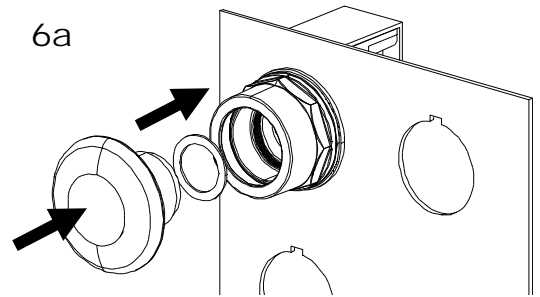

**Contact Operation:**

Torque Contact Block and Light Module retaining screws to 8 - 10 lb.in. [ 0.9 – 1.1 Nm ]

Maintained Push-Pull

Normally Open Contacts- use 52BAK contact block  
 Normally Closed Contacts- use 52BAJ contact block

Momentary Push-Pull - ( Factory assembled )

Normally Open Contacts- use 52BAJ contact block  
 ( Becomes Normally Open when assembled )  
 Normally Closed Contacts- use special 52BAU contact block which must be mounted last.

**Replacement Bulb Chart**

Volts	Incandescent Bulb	LED Lamp - Single Bulb				
		Red	Green	Yellow	White	Blue
6	# 755 *	52AEB2	52AEB3	52AEB4	52AEBB	52AEB5
24	# 757	52AED2	52AED3	52AED4	52AEDB	52AED5
120	N / A	52AEE2	52AEE3	52AEE4	52AEEB	52AEE5

\* Also Flashing Lamp #267