





LV HRC fuse link, NH2, In: 400 A, gG, Un AC: 500 V, Un DC: 440 V,  
Front indicator, non- insulated grip lugs



Figure similar

Model	
product brandname	SETRON
Product designation	LV HRC fuse link
Design of the product	With blade contacts
Design of an identification indicator	Front indicators
Design of the switching contact	Non-corroding, silver-plated
Design of the fuse link	LV HRC fuse link
General technical data	
Size of fuse system / acc. to DIN EN 60269-1	NH2
Operating class of the fuse link	gG
circuit-breaker / Design	3NA3
Supply voltage	
• at AC / rated value	500 V
• at DC	440 V
Protection class	
Protection class IP	IP20, with connected conductors

Switching capacity	
<b>Switching capacity current</b>	
<ul style="list-style-type: none"> <li>• at DC / acc. to IEC 60947-2 / rated value</li> </ul>	25 kA
<ul style="list-style-type: none"> <li>• acc. to IEC 60947-2 / rated value</li> </ul>	120 kA
Dissipation	
<b>Power loss [W]</b>	29 W
<b>Power loss [W]</b>	
<ul style="list-style-type: none"> <li>• for rated value of the current / at AC / in hot operating state / per pole</li> </ul>	29 W
Electricity	
rated current $I_n$ / IEC, DIN/VDE / at 40 Cel	380 A
Current / at AC / rated value	400 A
Mechanical Design	
<b>Width</b>	
<ul style="list-style-type: none"> <li>• of the enclosure</li> </ul>	57.8 mm
<b>Mounting position</b>	Any, preferably vertical
<b>Net weight</b>	661 g
Environmental conditions	
<b>Ambient temperature</b>	
<ul style="list-style-type: none"> <li>• minimum</li> </ul>	-5 °C
<ul style="list-style-type: none"> <li>• maximum</li> </ul>	40 °C
<ul style="list-style-type: none"> <li>• during storage</li> </ul>	Air humidity 90% at 20 °C
<b>Environmental category</b>	-20 to +50 at 95% relative humidity
Certificates	
<b>Equipment marking</b>	
<ul style="list-style-type: none"> <li>• acc. to DIN EN 61346-2</li> </ul>	F
<ul style="list-style-type: none"> <li>• acc. to DIN EN 81346-2</li> </ul>	F

General Product Approval				Declaration of Conformity	Test Certificates
 CCC	 CSA	 KEMA	 VDE	 EG-Konf.	<a href="#">Type Test Certificates/Test Report</a>

Test Certificates	Shipping Approval	other	
<a href="#">Special Test Certificate</a>	<a href="#">Miscellaneous</a>	 GL	<a href="#">Environmental Confirmations</a> <a href="#">Miscellaneous</a>

### Further information

**Information- and Downloadcenter (Catalogs, Brochures,...)**

<http://www.siemens.com/lowvoltage/catalogs>

**Industry Mall (Online ordering system)**

<https://mall.industry.siemens.com/mall/en/en/Catalog/product?mfb=3NA3260>

**Service&Support (Manuals, Certificates, Characteristics, FAQs,...)**

<https://support.industry.siemens.com/cs/ww/en/ps/3NA3260>

**Image database (product images, 2D dimension drawings, 3D models, device circuit diagrams, ...)**

[http://www.automation.siemens.com/bilddb/cax\\_en.aspx?mfb=3NA3260](http://www.automation.siemens.com/bilddb/cax_en.aspx?mfb=3NA3260)

**CAX-Online-Generator**

<http://www.siemens.com/cax>

**Tender specifications**

<http://www.siemens.com/specifications>

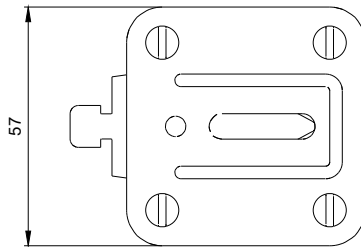
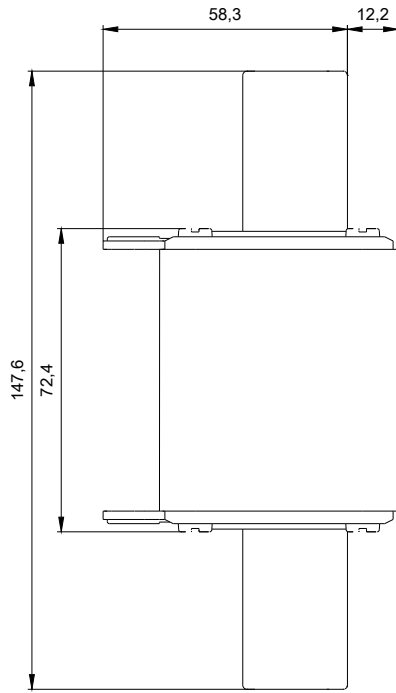

1

-F1

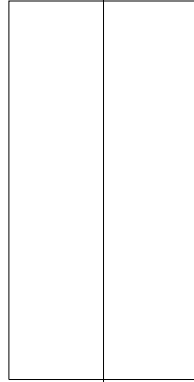

2